

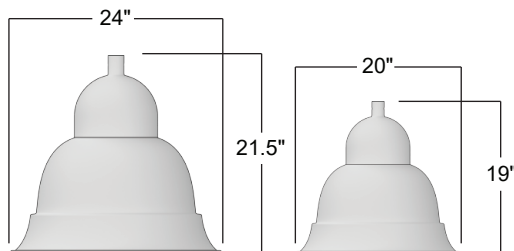

POLES & LIGHTING

## AVPL ENV - Architectural Bell Luminaire

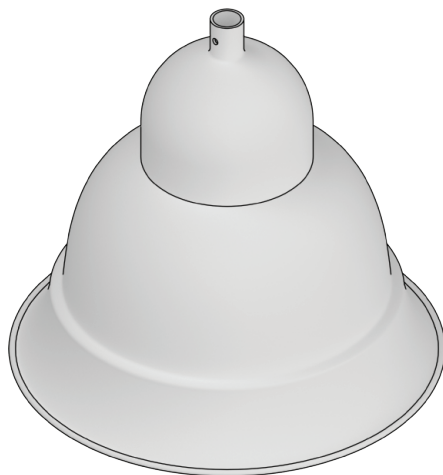

ENV-1



ENV-2

### Description

Decorative architectural design provides a unique lighting solution for a variety of applications. The ENV series by AV Poles and Lighting is ideal for commercial, municipal, and design build lighting applications.

### Materials

Durable, one-piece spun aluminum housing, aluminum door frame encases clear flat tempered glass lens.

Optics distribution delivered by a one piece horizontal reflector system which eliminates uplight and provides complete cutoff.

Reflector cavity made of segmented anodized aluminum. Optics Type III, IV, and V horizontal are available for medium base lamps.

Mogul and Medium base porcelain sockets.

TGIC thermoset polyester powder coat finish is electrostatically applied at a 3.0 mil nominal thickness. A five stage metal pre-treatment process and sealer provide maximum corrosion resistance. The powder top coat is baked in excess of 400 degrees for supreme endurance.

## Ordering Information

Luminaire	Lamp Type	Volts	Mounting	Finish	Options
<input type="checkbox"/> AVPL- ENV-1 <input type="checkbox"/> AVPL- ENV-2	<b>LED</b> 36W (700mA)   72W (700mA)   108W (700mA) <input type="checkbox"/> <input type="checkbox"/> <input type="checkbox"/> 56W (1A)   112W (1A)   168W (1A) <input type="checkbox"/> <input type="checkbox"/> <input type="checkbox"/>	<input type="checkbox"/> 120 <input type="checkbox"/> 208 <input type="checkbox"/> 240 <input type="checkbox"/> 277	<input type="checkbox"/> 1..... ○ <input type="checkbox"/> 2-90..... ○○ <input type="checkbox"/> 2-180..... ○○ <input type="checkbox"/> 3-90..... ○○○ <input type="checkbox"/> 3-120..... ○○○ <input type="checkbox"/> 4-90..... ○○○○ <input type="checkbox"/> Wall Mount..... ○	<input type="checkbox"/> Dark Bronze <input type="checkbox"/> Black <input type="checkbox"/> White <input type="checkbox"/> Grey <input type="checkbox"/> Green	<b>Optical</b> House Side Shield <input type="checkbox"/>  <b>Electrical</b> 10-20KV Surge Protector   0-10V Dimmable Driver(s)   Photo Cell + Voltage <input type="checkbox"/> <input type="checkbox"/> <input type="checkbox"/> High/Low Dimming for Hardwired Switching or Non-Integrated Motion Sensor <input type="checkbox"/>
<b>Optics</b> <input type="checkbox"/> Type III <input type="checkbox"/> Type IV <input type="checkbox"/> Type V	<b>PSMH</b> 50W   70W   100W <input type="checkbox"/> <input type="checkbox"/> <input type="checkbox"/> 150W   250W   400W <input type="checkbox"/> <input type="checkbox"/> <input type="checkbox"/>				<b>Color Temp</b> 3000K Warm   4000K Natural   5000K Cool <input type="checkbox"/> <input type="checkbox"/> <input type="checkbox"/>
	<b>HPS</b> 50W   70W   100W <input type="checkbox"/> <input type="checkbox"/> <input type="checkbox"/> 150W   250W   400W <input type="checkbox"/> <input type="checkbox"/> <input type="checkbox"/>				<input type="checkbox"/> = ENV-1 Only <input type="checkbox"/> = LED Only