



# COLORFUL RGB LED FLOOD LIGHT BRIGHTEN YOUR LIFE

NEW LED TECHNOLOGY THAT ALLOWS THE  
COEXISTENCE OF ENVIRONMENTAL  
PROTECTION AND ENERGY SAVING

## Benefits

1. Replace conventional Stadium Lights.
2. Precision Die Cast Aluminum Housing.
3. Fade Resistant Powder Coat Finish.
4. Easy Installation.
5. CE ROHS listed.



BB-LD-XXXW-Q2-RGB

## Features

1. Beam angle: 15°, 30°, 60°
2. Aluminum die-casting heat sinks is good for heat dissipation.
3. Rugged and weather-tight for use even in harsh environments.
4. Green, energy saving, long and reliable life of 50,000 hours.
5. No RF interference, No IR/UV radiation, no mercury pollution.
6. Custom-engineered optics precisely direct light while minimizing glare.
7. Streamline exterior design, beautiful appearance.
8. Environment friendly, energy saving (70~80%).
9. Special circuit design, each LED work separately, avoiding the single broken LED influence problem.

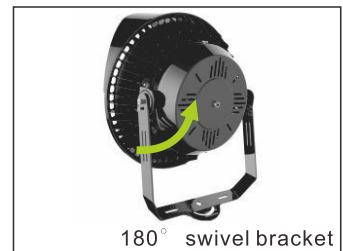
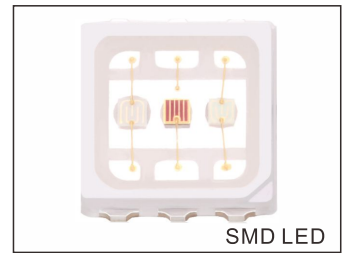

## Application

Amusement Led park floodlight is widely used in Ferris wheel, park, theme park, carnival, funfair, attractions rides and etc.





# SPECIFICATIONS

Power	400W	500W	600W
Model	BB-LD-400W-Q2-RGB	BB-LD-500W-Q2-RGB	BB-LD-600W-Q2-RGB
Luminous Efficacy (Lumen Output by Color)	Red= 4000LM ; Green=8000LM Blue=2000LM ; Amber=3000LM	Red= 5000LM ; Green= 10000LM Blue=2500LM ; Amber=3800LM	Red= 6000LM ; Green= 12000LM Blue=3000LM ; Amber=4500LM
Power	800W	1000W	1200W
Model	BB-LD-800W-Q2-RGB	BB-LD-1000W-Q2-RGB	BB-LD-1200W-Q2-RGB
Luminous Efficacy (Lumen Output by Color)	Red= 8000LM ; Green= 16000LM Blue=4000LM ; Amber=6000LM	Red= 10000LMGreen=20000LM Blue=5000LM ; Amber=7500LM	Red= 12000LM ; Green= 24000LM Blue=6000LM ; Amber=9000LM
Controller	DMX		
Beam Angle	15° 30° 60° (Optional)		
Dimension	See diagram below		
Luminous Source	3030 SMD LED / (1000W-1200W) 3535 SMD LED		
Operation Temp.	-40 to +45℃		
Life Span	50,000 hours at 25℃		
Voltage	100-277VAC/50-60HZ		
Driver	UL listed power supply		
Dimming	DIM 0-10V		
IP	65		
PF	>0.95		
Warranty	5Years		

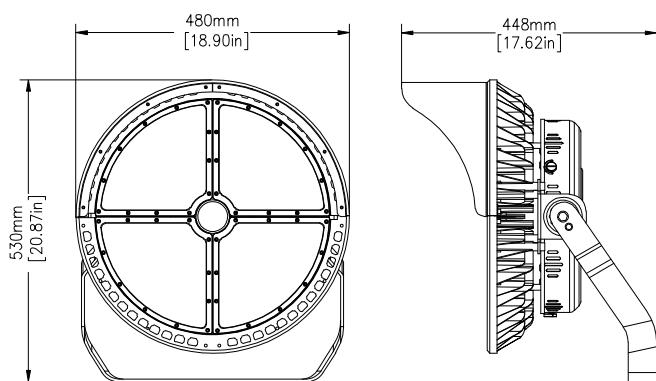

400W/500W

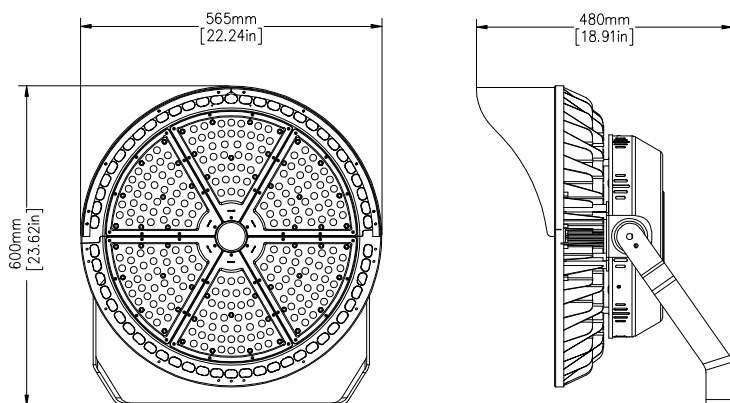

600W/800W

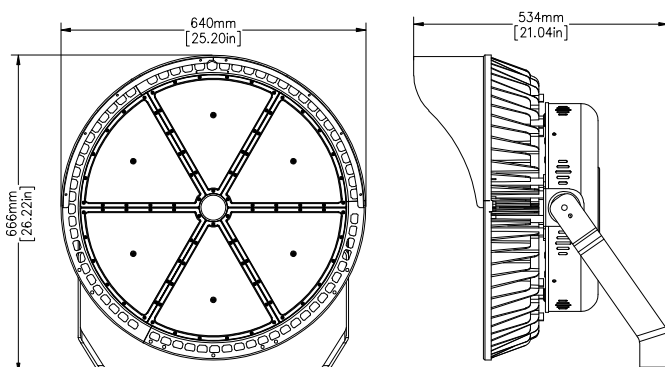

1000W/1200W

## DIMENSIONAL DRAWING

# LUMINOUS INTENSITY DISTRIBUTION

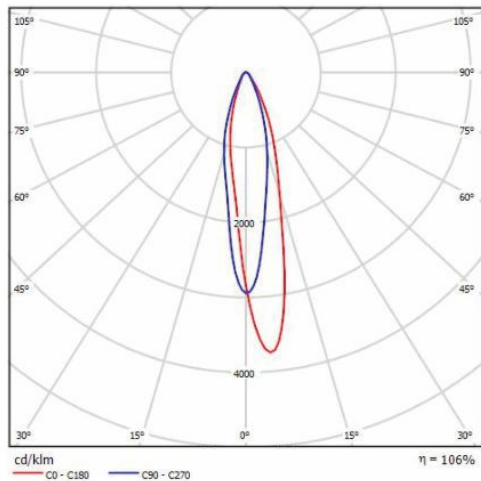

15 degree

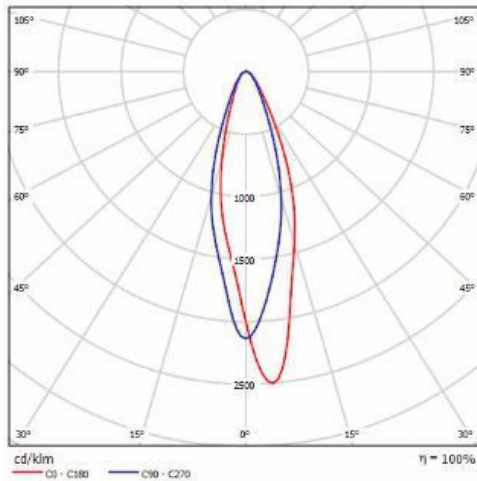

30 degree

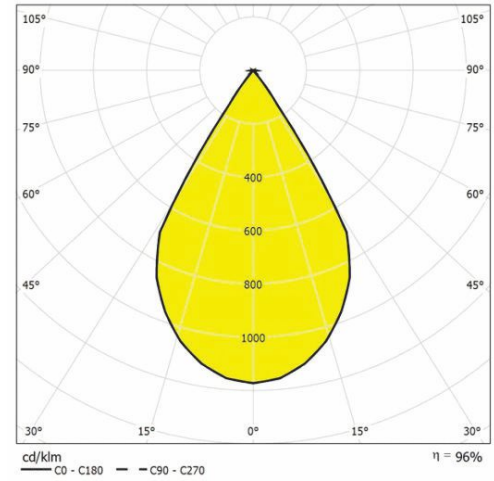

60 degree

## PROJECTS

By using our 400W RGB Flood Light to replace 1000W Metal Halide bulb for stadium lighting fixtures, the customer is now able to save a lot per month from his electric bill.



Replace



400W LED = 1200W MH

### Note:

- Don't take the LED lamp apart.
- The LED lamp must work under the right voltage according to the specification.

## PACKING INFO



Packaging	Carton Size(mm) (L*W*H)	N.W	G.W	Volume weight
400W/500W/1pc	790*440*140mm	17.5kg	18.5kg	17.0kg
600W/800W/1pc	690*630*270mm	24.5kg	26.0kg	25.0kg
1000-1200W/1pc	780*700*320mm	34.5kg	35.0kg	36.0kg

## Optional Accessories

Optional Accessories: Slip fitter.  
If you need, please contact sales.

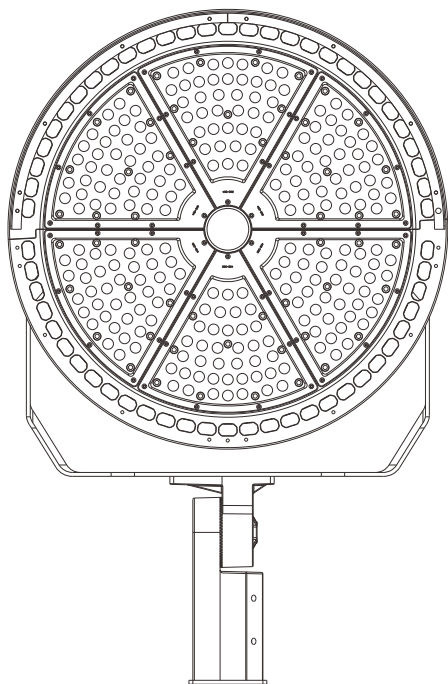

Slip fitter

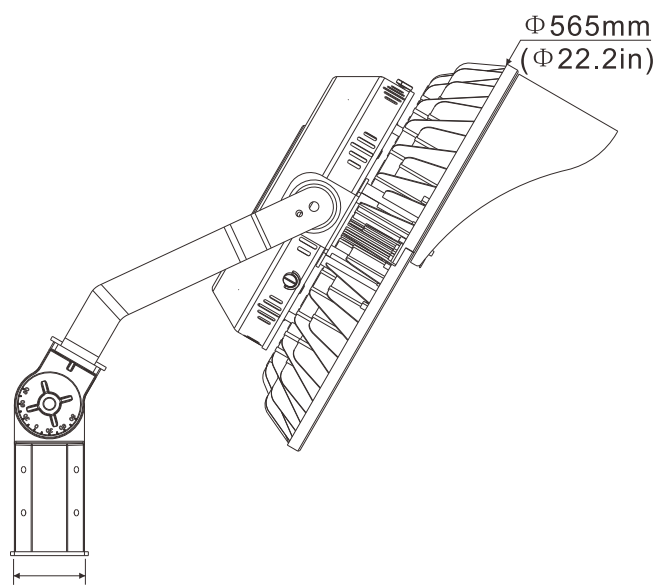

Inner diameter  
60mm(2.36in)

## DMX Control System



K-1000C (Controller)



DMX512(Decoker)

# K K-1000C

## System Features

- 1 32 to 65536 degree Gray control, Gamma correction procession handle.
- 2 Support various point, line light source, and all kinds of rules and specific shaped handle.
- 3 The controller has one output port, can support up to 512/2048 pixels(DMX lighting support up to 512 pixels).
- 4 Play content stored in the SD card , the SD card can store up to 32 effects File, SD card capacity support 128MB-32GB.
- 5 The controller can single set use,also multiple controllers cascade, cascade optical isolation mode: interference, better stability, cascade distance between two controllers can reach up to 150 meters, need to use 0.5M<sup>2</sup> pure copper power cord.
- 6 The controller support chip can lock the support IC in software, or not lock the support IC in the software, select the support IC through the controller CHIP button, this scheme is more flexible and convenient.
- 7 For the DMX lighting IC, the controller comes with write address function; In addition, with use of our 2016 LedEdit-K V3.26 or later edition can make one key write address function setting.
- 8 Support load lamp is 4 channels (RGBW) pixels, or split into single channel point pixels.
- 9 Enhanced 485 TTL and 485 differential (DMX) signal output.
- 10 The controller comes with the test effects were as follows: 1 red, green, blue and black jump; 2 red, green, blue and black gradient; 3 red, green, blue and goes.
- 11 The controller comes with 22 test effects and DMX512 channel test function.



## Technical Parameters

### Memory card:

Type: SD card

Capacity: 128MB—32GB

Format: FAT or FAT32

Storage file: \*.led

### Physical parameter:

Working temperature : -30°C—85°C

Working power: DC 5V -24V input

Power consumption: 2W

Weight: 0.35Kg

Data transmission interface:

3pin binding post

Size: L159mm\*W89mm\*H24mm

## Wiring Diagram

