

CLP-Decorative Arms
ARCHITECTURAL ARMS
DESIGN - QUALITY



Crystal 
Lighting

CLP-Decorative Arm 1

Architectural Arms

Decorative Arm 1 is constructed of Extruded Aluminum Tubing. Mount over Round Poles or Tenons of 3", 3-1/2", 4", 4-1/2", or 5" OD, DA1 and is secured with 3/8" Stainless Steel Set Screws. Contact us for custom configuration or others mounting. All Decorative Arms are Proudly Designed, Fabricated and Assembled in the USA.

DA1-SGL



DA1-D180



DA1-WM

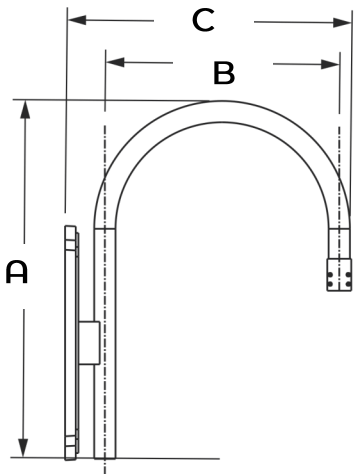
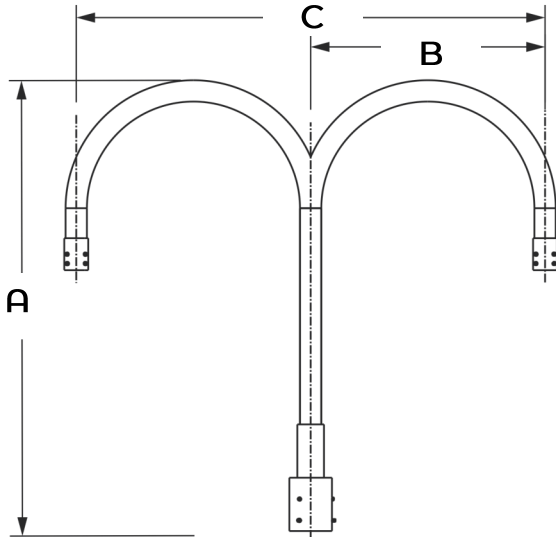
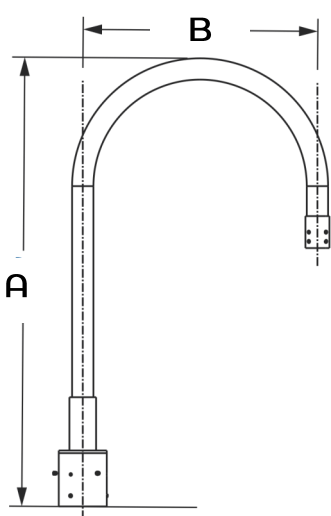

Dimensions				EPA
CAT#	A	B	C	
DA1-SGL	42"	22"	-	1.16
DA1-D180	42"	22"	44"	1.33
DA1-WM	33" 1/2	22"	27" 3/4	1.22



CAT #	mounting	DIAMETER Pole or Tenon	FINISH
Decorative Arm 1 (DA1)	Single (SGL)	3" OD (3)	Bronze (BRZ)
	Double 180° (D180)	3" 1/2 OD (3I2)	Black (BLK)
	Wall Mount (WM)	4" OD (4)	White (WHT)
		4" 1/2 OD (4I2)	Silver (SVR)
		5"OD (5)	Grey (GRY)
			Custom (CS)

CLP-Decorative Arm 2

Architectural Arms

Decorative Arm 2 is Constructed of Extruded Aluminum Tubing. Mount over Round Poles or Tenons of 3", 3-1/2", 4", 4-1/2", or 5" OD, DA2 and is secured with 3/8" Stainless Steel Set Screws. Contact us for custom configuration or others mounting. All Decorative Arms are Proudly Designed, Fabricated and Assembled in the USA.

DA2-SGL

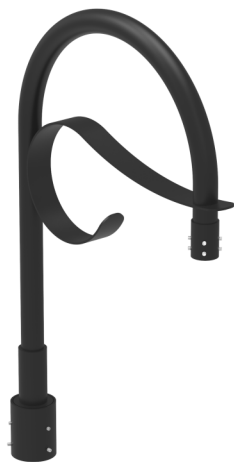

DA2-D180



DA2-WM

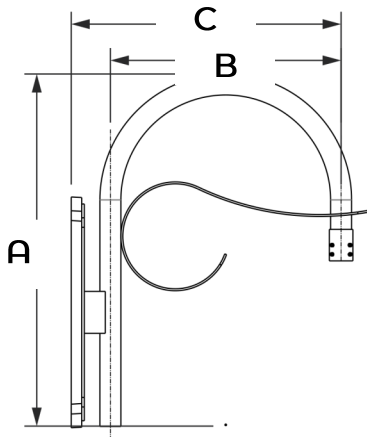
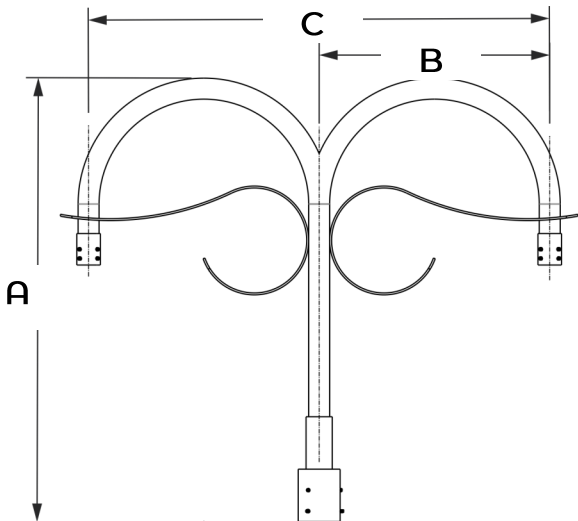
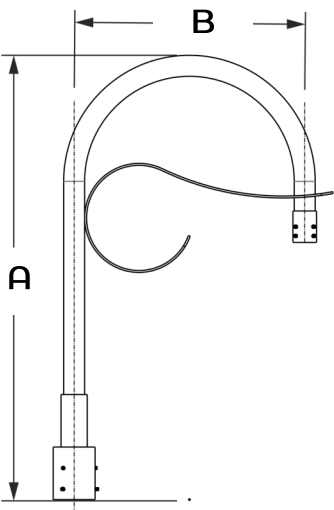

Dimensions				EPA
CAT#	A	B	C	
DA2-SGL	42"	22"	-	1.18
DA2-D180	42"	22"	44"	1.36
DA2-WM	33" 1/2	22"	27" 3/4	1.25



CAT #	mounting	DIAMETER Pole or Tenon	FINISH
Decorative Arm 2 (DA2)	Single (SGL)	3" OD (3)	Bronze (BRZ)
	Double 180° (D180)	3" 1/2 OD (3I2)	Black (BLK)
	Wall Mount (WM)	4" OD (4)	White (WHT)
		4" 1/2 OD (4I2)	Silver (SVR)
		5"OD (5)	Grey (GRY)
			Custom (CS)

CLP-Decorative Arm 3

Architectural Arms

Decorative Arm 3 is Constructed of Extruded Aluminum Tubing. Mount over Round Poles or Tenons of 3", 3-1/2", 4", 4-1/2", or 5" OD, DA3 and is secured with 3/8" Stainless Steel Set Screws. Contact us for custom configuration or others mounting. All Decorative Arms are Proudly Designed, Fabricated and Assembled in the USA.

DA3-SGL

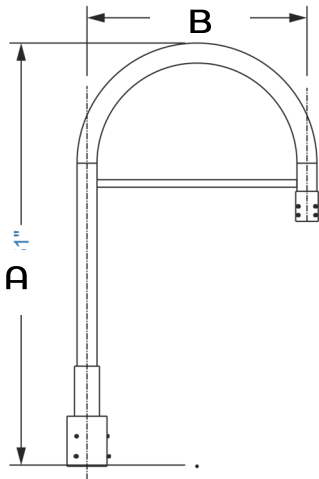

DA3-D180

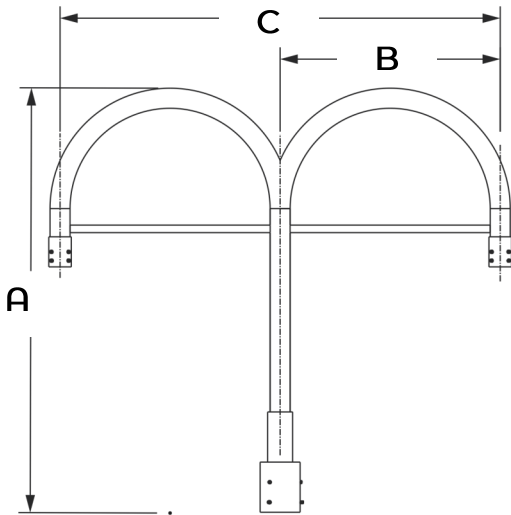

DA3-WM

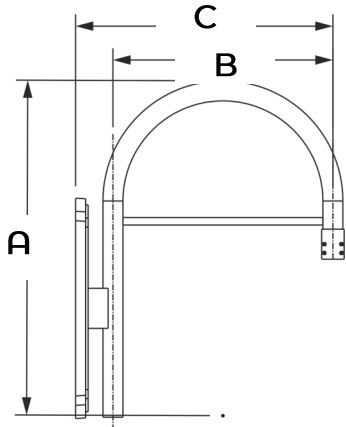

Dimensions				EPA
CAT#	A	B	C	
DA3-SGL	42"	22"	-	1.18
DA3-D180	42"	22"	44"	1.35
DA3-WM	33" 1/2	22"	27" 3/4	1.26



CAT #	mounting		DIAMETER Pole or Tenon	FINISH
Decorative Arm 3 (DA3)	Single	(SGL)	3" OD (3)	Bronze (BRZ)
	Double 180°	(D180)	3" 1/2 OD (312)	Black (BLK)
	Wall Mount	(WM)	4" OD (4)	White (WHT)
			4" 1/2 OD (412)	Silver (SVR)
			5"OD (5)	Grey (GRY)
				Custom (CS)

CLP-Decorative Arm 4

Architectural Arms

Decorative Arm 4 is Constructed of Extruded Aluminum Tubing. Mount over Round Poles or Tenons of 3-1/2" and, 4" OD, DA4 and is secured with 3/8" Stainless Steel Set Screws. Contact us for custom configuration or others mounting. All Decorative Arms are Proudly Designed, Fabricated and Assembled in the USA.

DA4-SGL



DA4-D180



DA4-WM

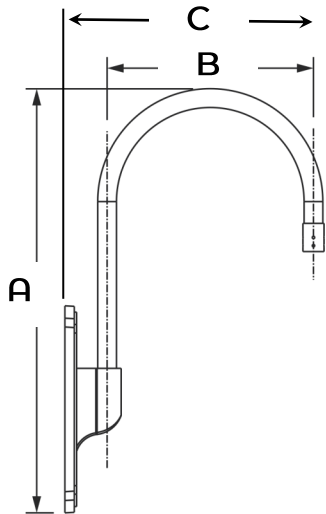
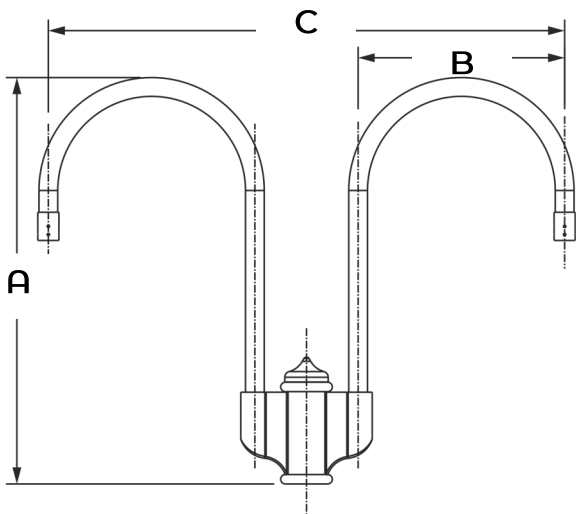
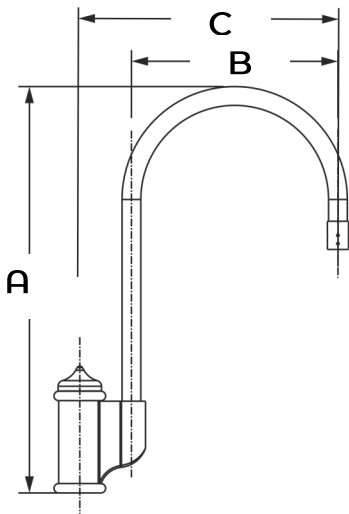

Dimensions				EPA
CAT#	A	B	C	
DA4-SGL	43"	22"	27" 1/2	1.2
DA4-D180	43"	22"	55"	2.5
DA4-WM	45"	22"	26" 1/2	1.4



CAT #	mounting	DIAMETER Pole or Tenon	FINISH
Decorative Arm 4 (DA4)	Single (SGL)	3" 1/2 OD (312)	Bronze (BRZ) Black (BLK) White (WHT) Silver (SVR) Grey (GRY) Custom (CS)
	Double 180° (D180)	4" OD (4)	
	Wall Mount (WM)		

CLP-Decorative Arm 5

Architectural Arms

Decorative Arm 5 is Constructed of Extruded Aluminum Tubing. Mount over Round Poles or Tenons of 3", 3-1/2", 4", 4-1/2", or 5" OD, DA5 and is secured with 3/8" Stainless Steel Set Screws. Contact us for custom configuration or others mounting. All Decorative Arms are Proudly Designed, Fabricated and Assembled in the USA.

DA5-SGL

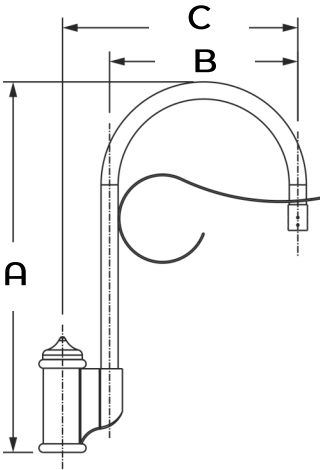

DA5-D180

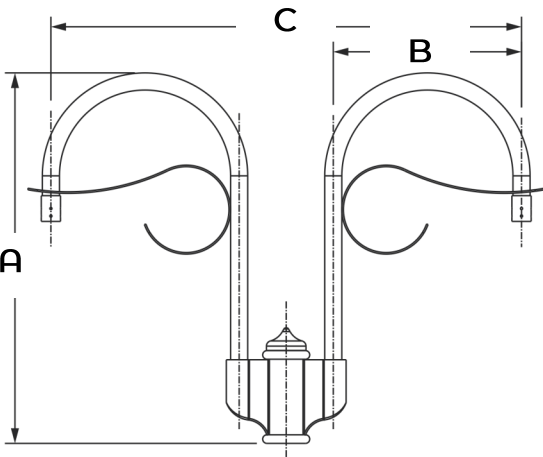

DA5-WM

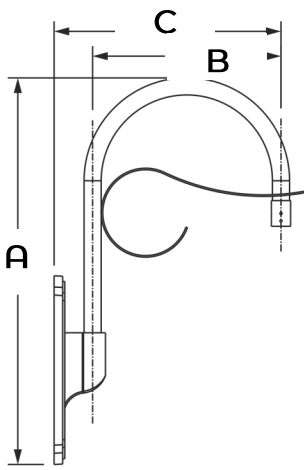

Dimensions				EPA
CAT#	A	B	C	
DA5-SGL	43"	22"	27" 1/2	1.23
DA5-D180	43"	22"	55"	2.53
DA5-WM	45"	22"	26" 1/2	1.43



CAT #	MOUNTING		DIAMETER Pole or Tenon	FINISH
Decorative Arm 5 (DA5)	Single	(SGL)	3" 1/2 OD (312)	Bronze (BRZ) Black (BLK) White (WHT) Silver (SVR) Grey (GRY) Custom (CS)
	Double 180°	(D180)	4" OD (4)	
	Wall Mount	(WM)		

CLP-Decorative Arm 6

Architectural Arms

Decorative Arm 6 is Constructed of Extruded Aluminum Tubing. Mount over Round Poles or Tenons of 3", 3-1/2", 4", 4-1/2", or 5" OD, DA6 and is secured with 3/8" Stainless Steel Set Screws. Contact us for custom configuration or others mounting. All Decorative Arms are Proudly Designed, Fabricated and Assembled in the USA.

DA6-SGL



DA6-D180



DA6-WM

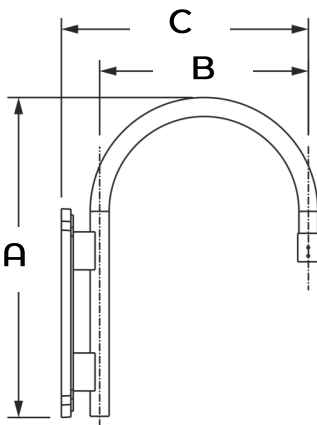
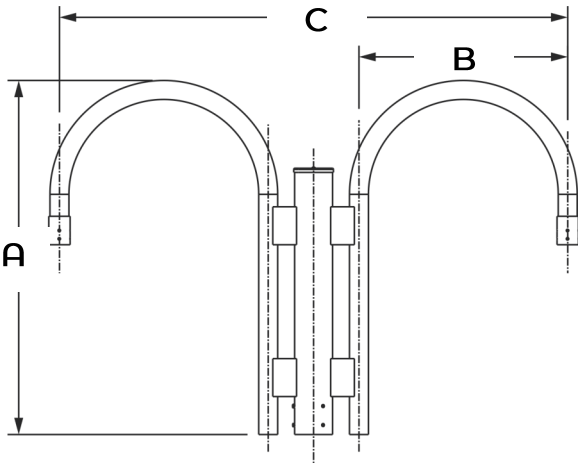
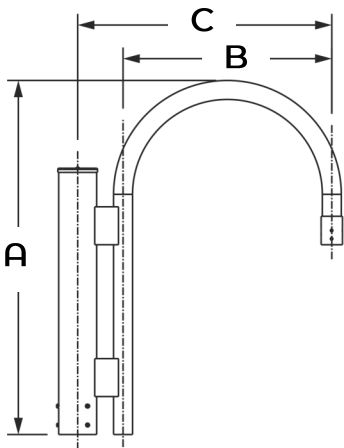

Dimensions				EPA
CAT#	A	B	C	
DA6-SGL	37" 3/8	22"	26" 3/4	1.9
DA6-D180	37" 3/8	22"	53" 1/2	3.1
DA6-WM	33" 3/4	22"	26"	1.5



CAT #	mounting		DIAMETER Pole or Tenon	FINISH
Decorative Arm 6 (DA6)	Single	(SGL)	3" OD (3)	Bronze (BRZ)
	Double 180°	(D180)	3" 1/2 OD (312)	Black (BLK)
	Wall Mount	(WM)	4" OD (4)	White (WHT)
			4" 1/2 OD (412)	Silver (SVR)
			5"OD (5)	Grey (GRY)
				Custom (CS)

CLP-Decorative Arm 7

Architectural Arms

Decorative Arm 7 is Constructed of Cast Aluminum and Extruded Aluminum Fitter. Mount over Round Poles or Tenons of 3", 3-1/2", 4", 4-1/2", or 5" OD, DA7 and is secured with 3/8" Stainless Steel Set Screws. Contact us for custom configuration or others mounting. All Decorative Arms are Proudly Designed, Fabricated and Assembled in the USA.

DA7-SGL

DA7-D180

DA7-WM

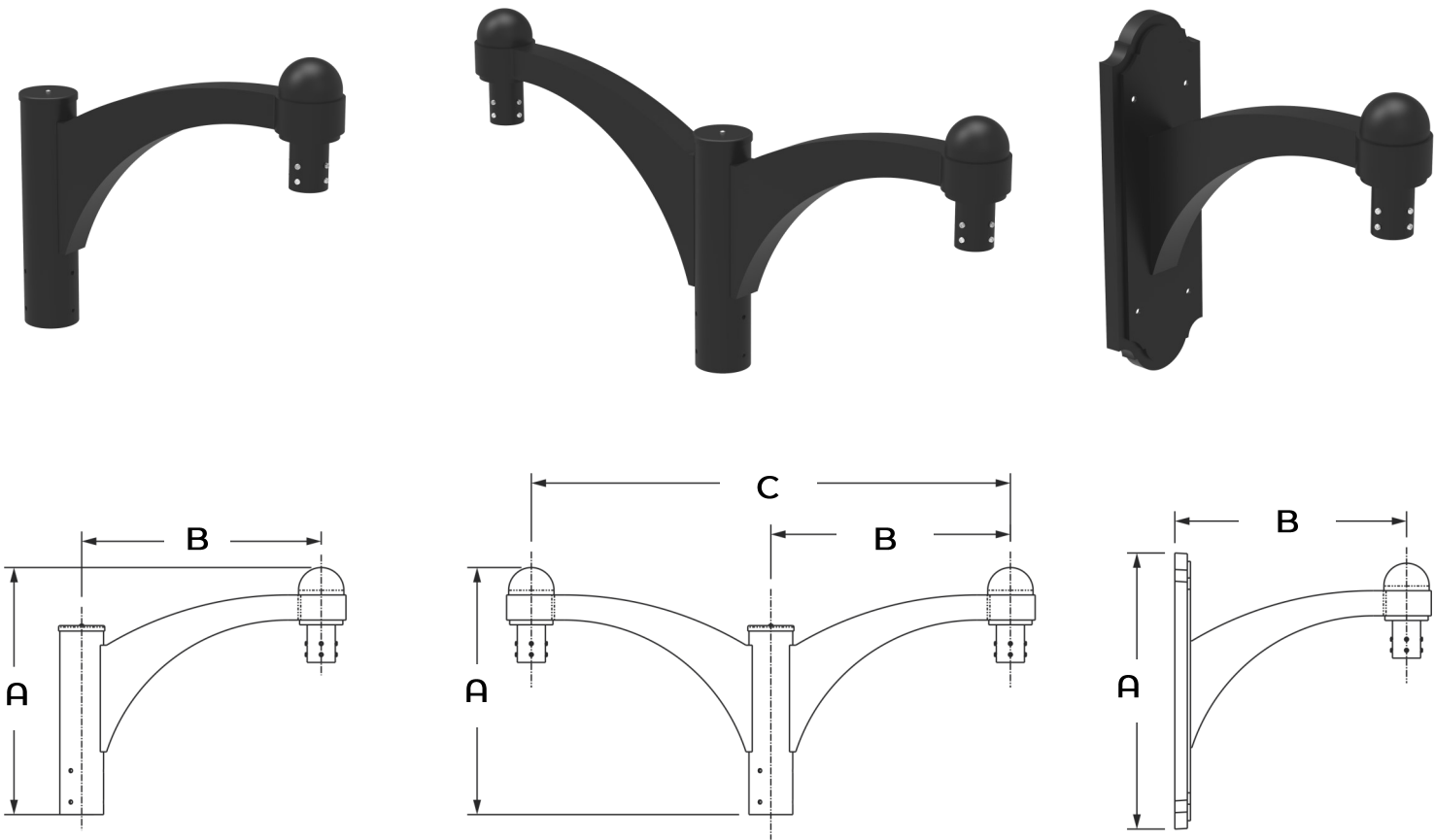

Dimensions				EPA
CAT#	A	B	C	
DA7-SGL	19" 3/4	19" 1/4	-	.9
DA7-D180	19" 3/4	19" 1/4	38" 3/8	1.43
DA7-WM	18" 1/2	22"	-	.71



CAT #	mounting	DIAMETER Pole or Tenon	FINISH
Decorative Arm 7 (DA7)	Single (SGL)	3" OD (3)	Bronze (BRZ)
	Double 180° (D180)	3" 1/2 OD (312)	Black (BLK)
	Wall Mount (Wm)	4" OD (4)	White (WHT)
		4" 1/2 OD (412)	Silver (SVR)
		5"OD (5)	Grey (GRY)
			Custom (CS)

CLP-Decorative Arm 8

Architectural Arms

Decorative Arm 8 is Constructed of Extruded Aluminum Tubing. Mount over Round Poles or Tenons of 3", 3-1/2", 4", 4-1/2", or 5" OD, DA8 and is secured with 3/8" Stainless Steel Set Screws. Contact us for custom configuration or others mounting. All Decorative Arms are Proudly Designed, Fabricated and Assembled in the USA.

DA8-SGL



DA8-D180



DA8-WM

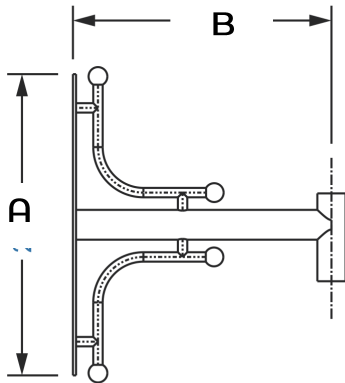
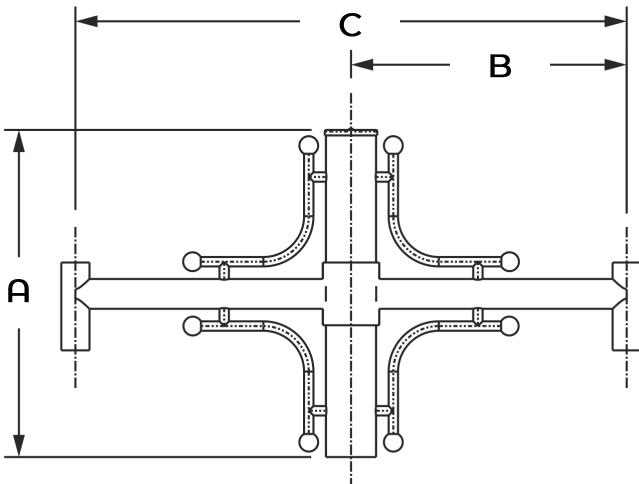
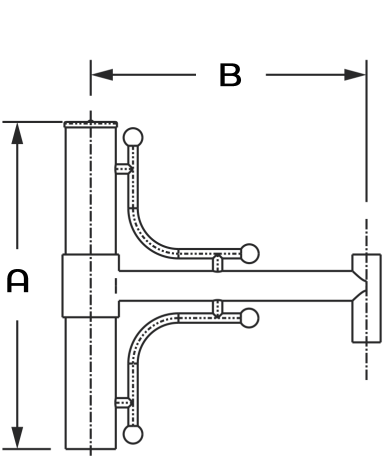

Dimensions				EPA
CAT#	A	B	C	
DA8-SGL	26"	22"	-	1.39
DA8-D180	26"	22"	44"	2.03
DA8-WM	24"	20" 5/8	-	.70



CAT #	mounting	DIAMETER Pole or Tenon	FINISH
Decorative Arm 8 (DA8)	Single (SGL)	3" OD (3)	Bronze (BRZ)
	Double 180° (D180)	3" 1/2 OD (312)	Black (BLK)
	Wall Mount (WM)	4" OD (4)	White (WHT)
		4" 1/2 OD (412)	Silver (SVR)
		5"OD (5)	Grey (GRY)
			Custom (CS)

CLP-Decorative Arm 9

Architectural Arms

Decorative Arm 9 is Constructed of Extruded Aluminum Tubing. Mount over Round Poles or Tenons of 3", 3-1/2", 4", 4-1/2", or 5" OD, DA9 and is secured with 3/8" Stainless Steel Set Screws. Contact us for custom configuration or others mounting. All Decorative Arms are Proudly Designed, Fabricated and Assembled in the USA.

DA9-SGL



DA9-D180



DA9-WM

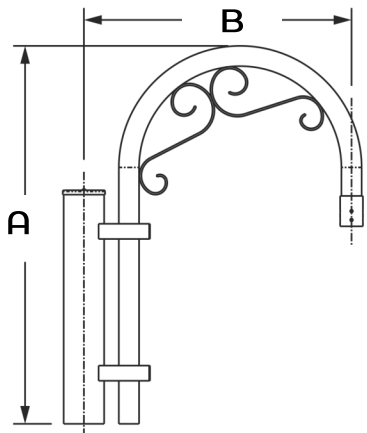
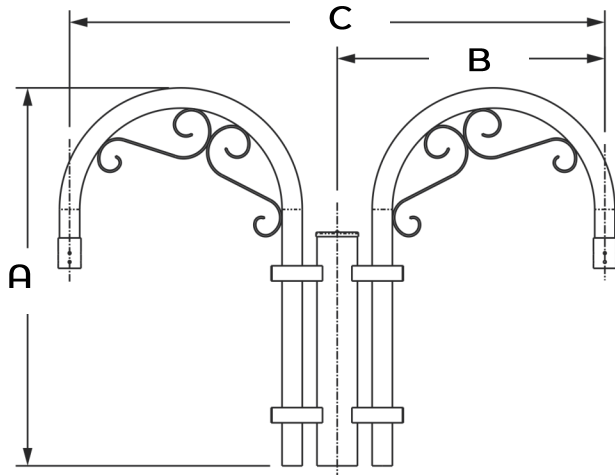
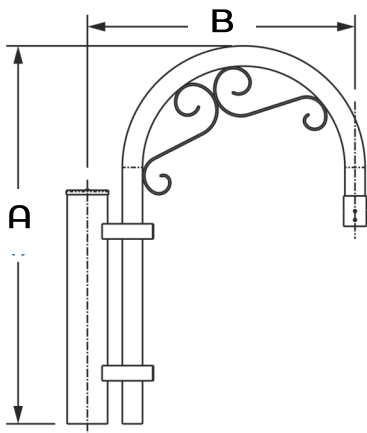

Dimensions				EPA
CAT#	A	B	C	
DA9-SGL	37" 3/8	26" 1/2	-	1.9
DA9-D180	37" 3/8	26" 1/2	53"	3.1
DA9-WM	34" 7/8	25" 1/4	-	1.5



CAT #	mounting	DIAMETER Pole or Tenon	FINISH
Decorative Arm 9 (DA9)	Single (SGL)	3" OD (3)	Bronze (BRZ)
	Double 180° (D180)	3" 1/2 OD (312)	Black (BLK)
	Wall Mount (WM)	4" OD (4)	White (WHT)
		4" 1/2 OD (412)	Silver (SVR)
		5"OD (5)	Grey (GRY)
			Custom (CS)

CLP-Decorative Arm 10

Architectural Arms

Decorative Arm 10 is Constructed of Extruded Aluminum Tubing. Mount over Round Poles or Tenons of 3", 3-1/2", 4", 4-1/2", or 5" OD, DA10 and is secured with 3/8" Stainless Steel Set Screws. Contact us for custom configuration or others mounting. All Decorative Arms are Proudly Designed, Fabricated and Assembled in the USA.

DA10-SGL



DA10-D180

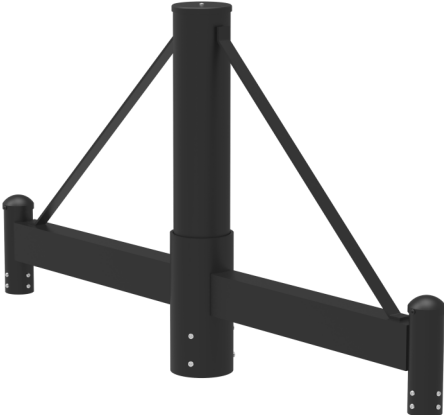

DA10-WM

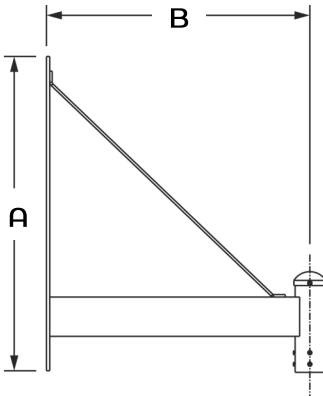
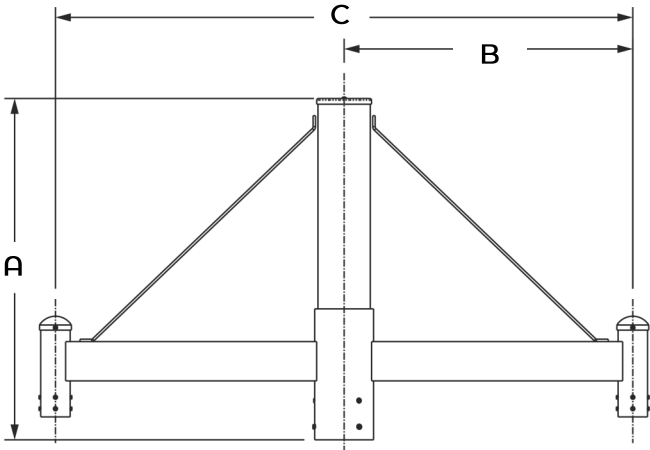
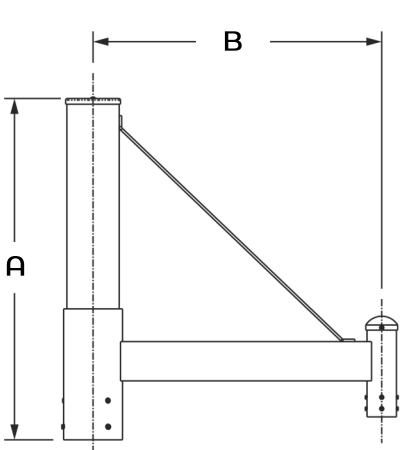
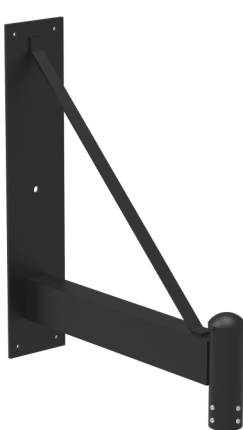

Dimensions				EPA
CAT#	A	B	C	
DA10-SGL	26	22"	-	1.27
DA10-D180	26	22"	44"	1.82
DA10-WM	26	22"	-	.7



CAT #	mounting	DIAMETER Pole or Tenon	FINISH
Decorative Arm 10 (DA10)	Single (SGL)	3" OD (3)	Bronze (BRZ)
	Double 180° (D180)	3" 1/2 OD (312)	Black (BLK)
	Wall Mount (WM)	4" OD (4)	White (WHT)
		4" 1/2 OD (412)	Silver (SVR)
		5"OD (5)	Grey (GRY)
			Custom (CS)

CLP-X155

Architectural Arms

CLP-X155 is Constructed of Cast Aluminum . Mount over Round Poles or Tenon of 3", 3-1/2", and 4" O.D., CLP-X155 is secured with 3/8" Stainless Steel Set Screws.

Contact us for custom configuration or others mounting. All Decorative Arms are Proudly Designed, Fabricated and Assembled in the USA.

CLP-X155-SGL

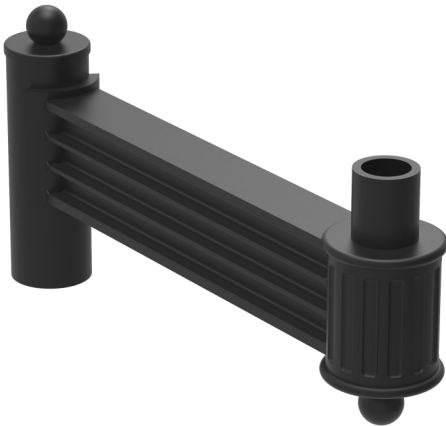

CLP-X155-D180

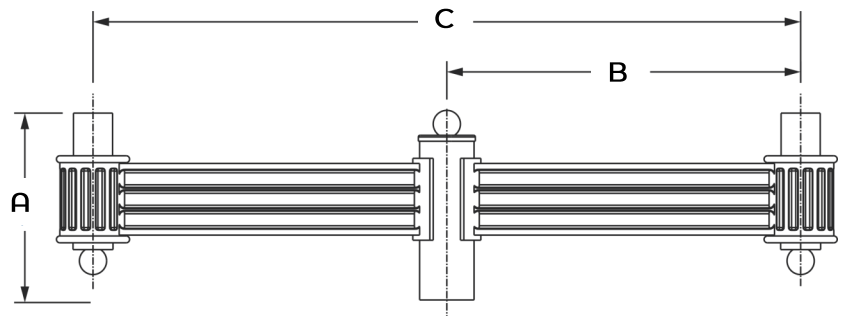
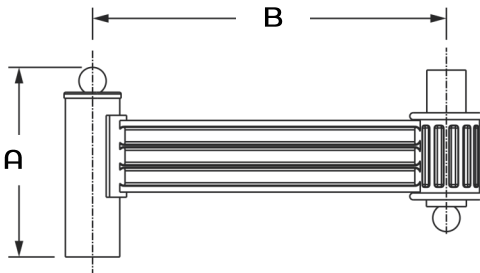

Dimensions				EPA
CAT#	A	B	C	
CLP-X155-SGL	14	26"	-	1.45
CLP-X155-D180	14	26"	52"	2.55



CAT #	mounting	DIAMETER Pole or Tenon	FINISH
CLP-X155 (CLP-X155)	Single (SGL) Double 180° (D180)	3" OD (3) 3" 1/2 OD (312) 4" OD (4)	Bronze (BRZ) Black (BLK) White (WHT) Silver (SVR) Grey (GRY) Custom (CS)

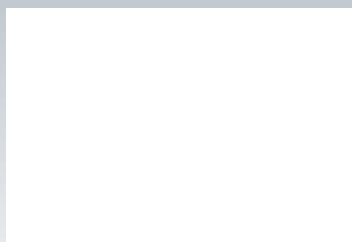
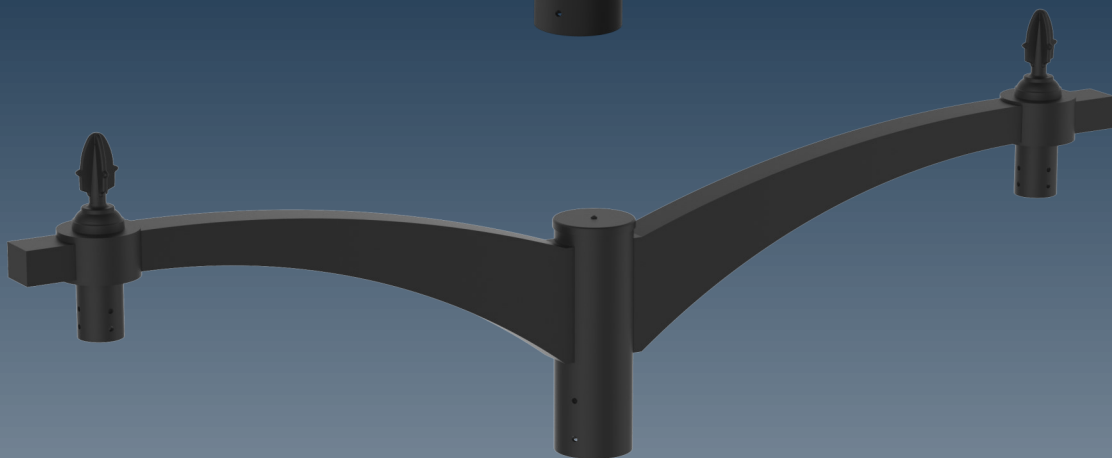
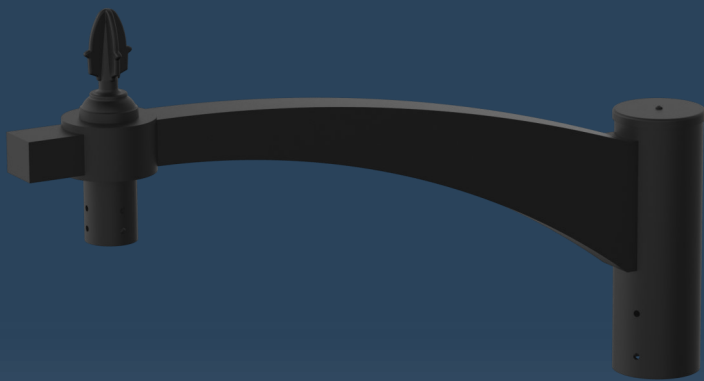

All products are proudly manufactured and/or assembled in the USA