

RLM Series

Architectural LED Lighting
DESIGN-FUNCTION-QUALITY



Crusta Lighting Corp.





RLM Shades are made from Spun 0.080 High purity aluminum. Arms are formed from 1/2 or 3/4 NPT Aluminum Pipe.

Finish

-3 Mil Powder-Coat, Variety of standard and custom finishes are available.

Features.

- 0-10 Volt Dimming
- Driver: Constant current, 120-277v, 50/60Hz, 480v (optional)
- 10 Year limited Warranty
- Suitable for wet locations

Shade Dimensions		
CAT#	D	H
CLA-SHS	12"	8"
CLA-SH1	16"	9" 1/2
CLA-SH2	18"	9" 1/2
BRN-SH1	16"	9"
SLD-SH1	9" 1/2	6" 1/2

OPTIC DISTRIBUTION

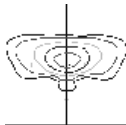

TYPE 3 (T3)

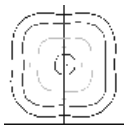

TYPE 5 (T5)

Example: CLA-SHS-10CLED-T3-40K-MV-BZ-ST6-OAL



LISTED

PHILIPS
LUMILEDS

POWDER
COATED
TOUGH

Wireless Controls
Available

NEMA



Cat #	Shade Diameter	Wattage	Light Dist.	Color Temp.	Voltage	Finish	Mounting	Options
Classic (CLA)	12" Shade Small (SHS) 16"Shade 1 (SH1) 18"Shade 2 (SH2)	10W (10CLED) 20W (20CLED) 30W (30CLED)	Type 3 (T3) Type 5 (T5)	3000K (30K) 4000K (40K) 5000K (50K)	120-277V (MV) 480V (HV)	Aluminum Black (BLK) White (WHT) Silver (SLR) Bronze (BRZ) Graphite (GPH) Marine Grade (MG) Custom (CST)	Pole Mount Arm1 (A1) Wall Mount Arm2 (A2) Arm3 (A3) Arm4 (A4) Arm5 (A5) Arm6 (A6) Arm7 (A7) STEM (ST) CORD (CR) 6" (6) 12" (12) 18" (18) 24" (24) Custom (CST)	Frosted Acrylic Lens (FAL) Opal Acrylic Lens (FAL)
Barn (BRN)	16" Shade 1 (SH1)							
Slanted (SLD)	9"1/2 Shade 1 (SH1)					Steel Galvarvanized (GVZ)		

Shade Options



Classic



Barn



Slanted

Arms Options

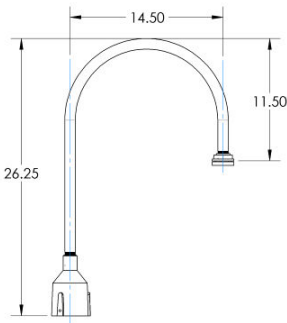

Arm-1 (26"1/4 x 14"1/2)

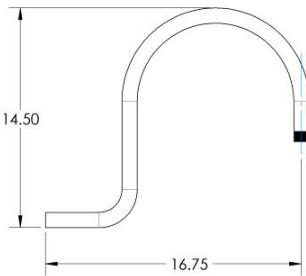

Arm-2 (14"1/2 x 17"1/4)

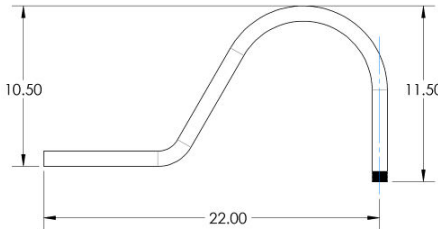

Arm-3 (22"x 10" 1/2)

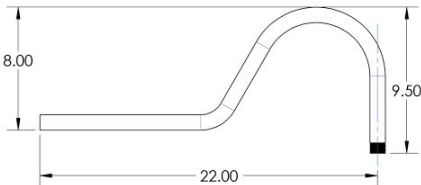

Arm-4 (22"x 8")

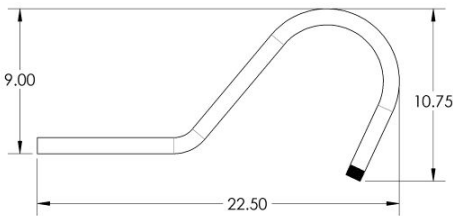

ARM-5 (22" 1/2 x 9")

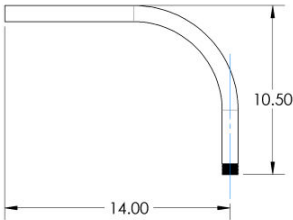

ARM-6 (14"x 10"1/2)

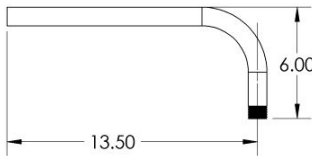

ARM-7 (13"1/2 x 6")

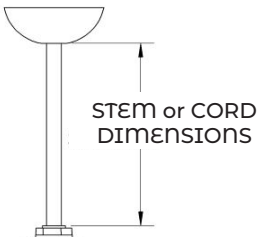

STEM or CORD



Proudly manufactured and assembled in the USA