



## ■ Features:

- Zone 1&2, Zone 21&22
- Instant on crisp white light output
- High efficiency drivers and LEDs provide, low cost operation in harsh and heavy industrial applications
- Isolated LED compartment reduces temperature within driver housing
- Multi choice of beam angle for 60° 90° 120°

## Applications

- Typical applications include:
- Oil and gas industries
- Chemical, petrochemical
- Pharmaceutical industries
- Pulp and Paper
- Waste and sewage treatment
- Power Generation

## Standard Materials

- Housing: Die-casting aluminum
- Exterior: Stainless steel
- Globe: Tempered glass
- Gasket: Silicon rubber

## Certifications

ATEX  
CNEX  
CE  
RoHS  
ISO9001





20-100W LED explosion proof light

## GYD680-T series

GYD6801-T



### Explosion protection

European (ATEX) Gas and Dust	<b>CE 1282</b>  II 2G Ex d e IIC T6 <b>CE 1282</b>  II 2D Ex tb T80°C
For use in	Zone 1, 2 & Zone 21, 22

### Electrical data

Rated voltage	100-240VAC, 50-60Hz
Power factor	>0.95
THD	<20%

### Luminous characteristics

Power consumption [W]	50W,75W,100W
Colour rendering [CRI]	70 (±2)
Colour temperature [K]	5500-6000K
Luminaire efficiency [Lm/W]	120-130
Beam angle	120° (60°, 90° is optional)

### Mechanical data

Degree of protection	IP66
Cable entry	G 3/4" ; NPT3/4"
Dimension[mm]	260*260*385
Weight [kg]	8.25
Terminal	≤2.5 mm <sup>2</sup>
Mounting Styles	Ceiling; Wall Bracket; Pendant,Pole Mounted



20-100W LED explosion proof light

**GYD680-T** series

### Dimension

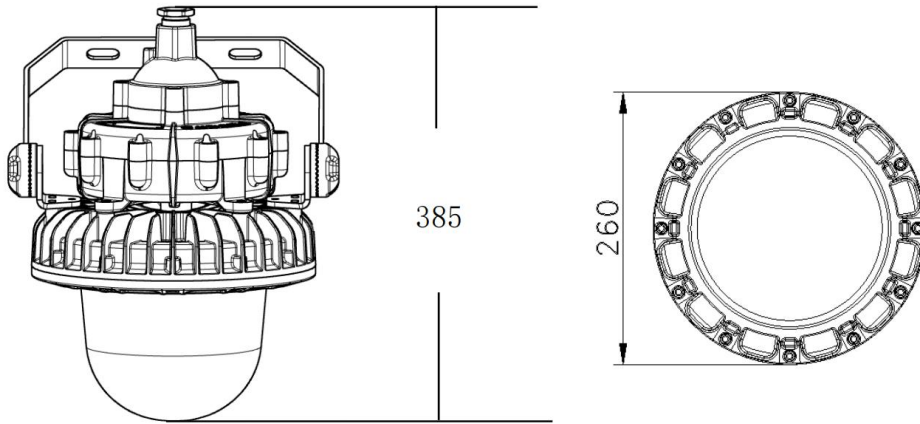

### Installation

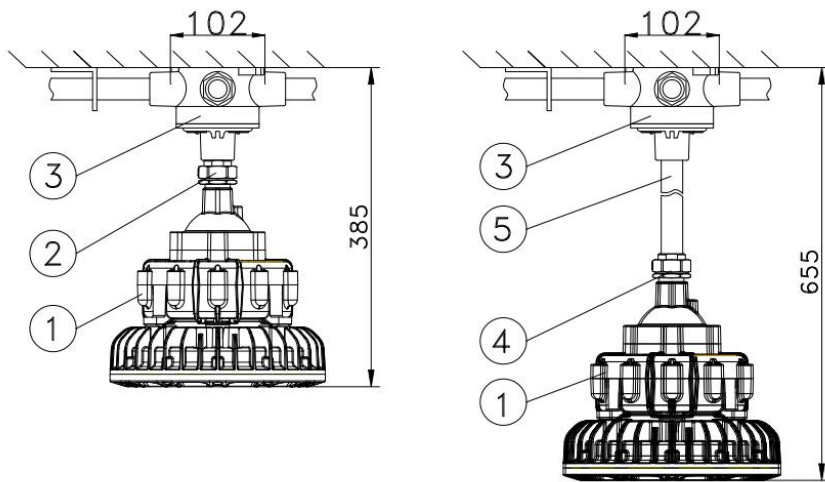

**Ceiling Mount**

**Pendant**



20-100W LED explosion proof light

GYD680-T series

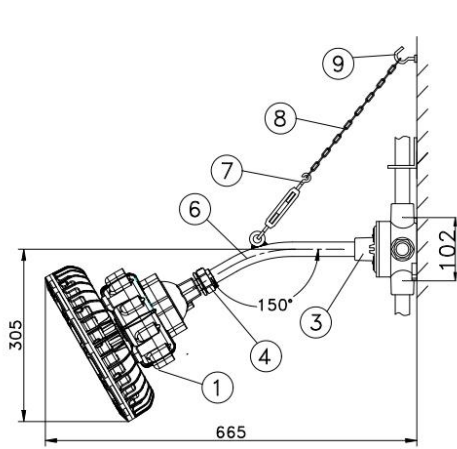

Wall Mount

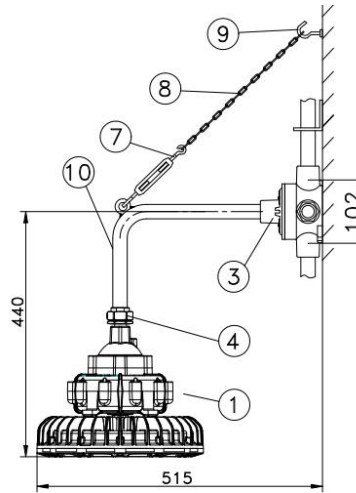

Wall Mount II

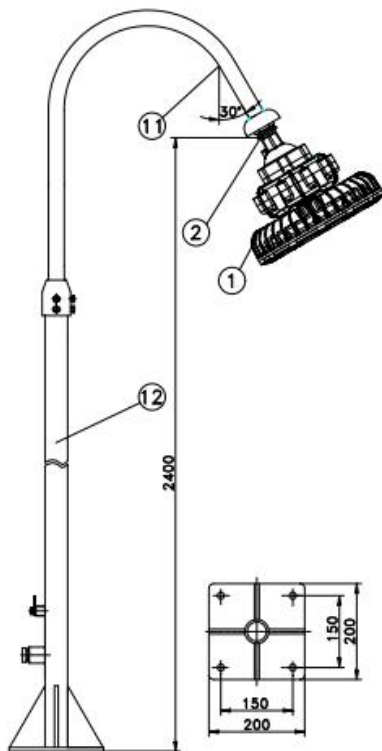

Stanchion I

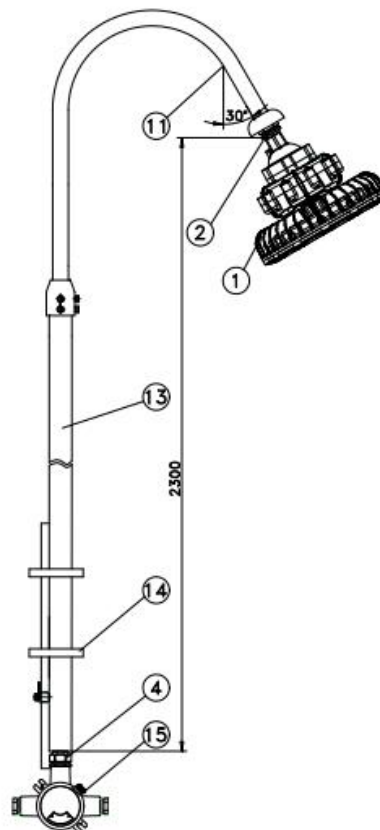

Stanchion II